

ERROR DETECTION

Troubleshooting at the remote control LCD

UTY-RNRYZ1 (2-wire type)

1. If an error occurs, an error icon appears on the “Monitor mode screen”.
Touch the [Status] button. The “Status” screen is displayed.
2. Touch the [Error Information] button. The “Error Information” screen is displayed.
(When there are no errors, the [Error Information] will not be displayed.)
3. Double-digit numbers correspond to the error code in the table next page.
Touch the [Next page] (or [Previous page]) to switch to the other connected indoor units.

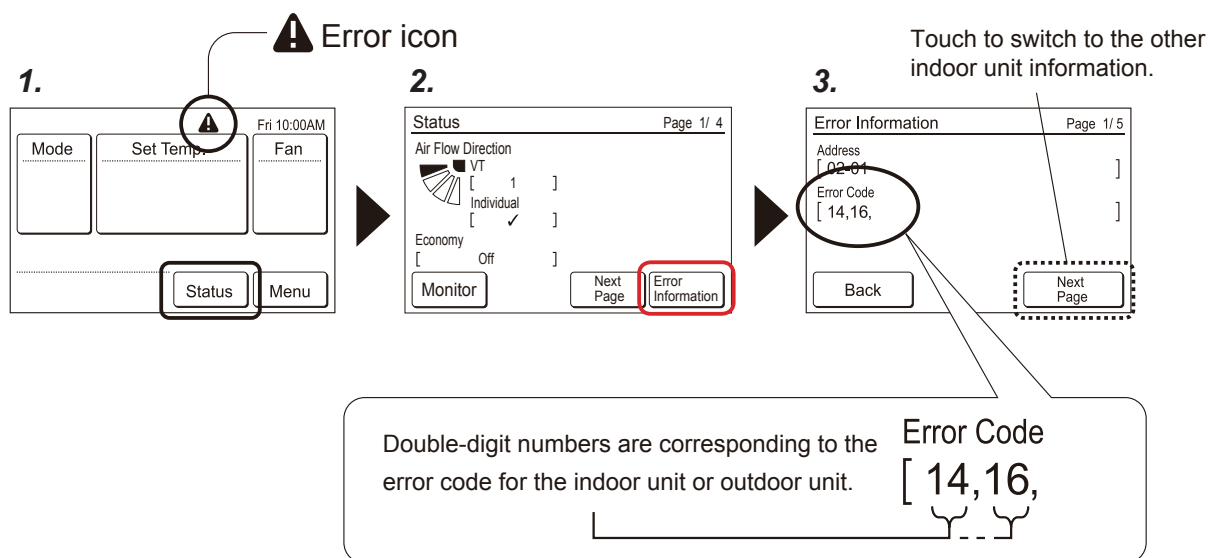

Triple-digit error code means the error of remote control itself.

Error code	Contents
CC.1	Sensor error
C2.1	Transmission PCB error
12.1	Wired remote control communication error
12.3	Number excess of device in wired remote control system
12.4	Wired remote control system start-up error
26.4	Address duplication in wired remote control system
26.5	Address setting error in wired remote control system
15.4	Data acquisition error

Error History (Triple-digit)

- (1) Touch the [Error History] on the “Maintenance” screen.

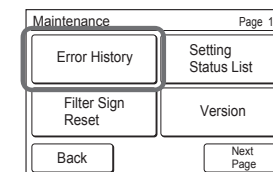

- (2) “Error History” screen is displayed. When the screen has multiple pages, they can be switched by touching the [Next Page] or [Previous Page].

No.	Date	Time	Address	Code
1	2015/ 8/ 1	11:00AM	002-01	141
2	2015/ 7/30	2:53AM	002-02	143
3	2015/ 7/25	8:53AM	002-02	143
4	2015/ 7/22	11:00AM	002-01	141
5	2015/ 7/22	11:00AM	002-01	141
6	2015/ 7/21	11:00AM	002-01	141

No.	Date	Time	Address	Code
7	2015/ 7/ 1	11:00AM	002-01	141
8	2015/ 7/10	2:53AM	002-02	143
9	2015/ 7/ 5	8:53AM	002-02	143
10	2015/ 7/ 2	11:00AM	002-01	141
11	2015/ 7/ 2	11:00AM	002-01	141

- (3) When the [Back] is touched after verification, the display returns to the “Maintenance” screen.

Erase the Error History

- (1) Touch the [Erase All] on the “Error History” screen.
- (2) A verification screen is displayed. When the [Yes] is touched after the history is cleared, the display returns to the “Error History” screen.

No.	Date	Time	Address	Code
1	2015/ 8/ 1	11:00AM	002-01	141
2	2015/ 7/30	2:53AM	002-02	143
3	2015/ 7/25	8:53AM	002-02	143
4	2015/ 7/22	11:00AM	002-01	141
5	2015/ 7/22	11:00AM	002-01	141
6	2015/ 7/21	11:00AM	002-01	141

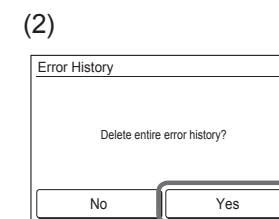

If you use a wired type remote control, error codes will appear on the remote control display. When you use a wireless remote control, the lamps on the IR receiver unit will output error codes by way of blinking patterns. See the lamp blinking patterns and error codes in the table. An error display is displayed only during running.

UTY-RNRYZ1
Double-digit error code means the error for the indoor unit or outdoor unit.

Error display			Wired remote controller Error code	Description
OPERATION lamp (green)	TIMER lamp (orange)	ECONOMY lamp (green)		
●(1)	●(1)	◇	11	Serial communication error
●(1)	●(2)	◇	12	Wired remote controller communication error
●(1)	●(5)	◇	15	Check run unfinished
●(1)	●(6)	◇	16	Peripheral unit transmission PCB connection error
●(1)	●(8)	◇	18	External communication error
●(2)	●(1)	◇	21	Unit number or Refrigerant circuit address setting error [Simultaneous Multi]
●(2)	●(2)	◇	22	Indoor unit capacity error
●(2)	●(3)	◇	23	Combination error
●(2)	●(4)	◇	24	• Connection unit number error (indoor secondary unit) [Simultaneous Multi] • Connection unit number error (indoor unit or branch unit) [Flexible Multi]
●(2)	●(6)	◇	26	Indoor unit address setting error
●(2)	●(7)	◇	27	Primary unit, secondary unit setup error [Simultaneous Multi]
●(2)	●(9)	◇	29	Connection unit number error in wired remote controller system
●(3)	●(1)	◇	31	Power supply interruption error
●(3)	●(2)	◇	32	Indoor unit PCB model information error
●(3)	●(5)	◇	35	Manual auto switch error
●(3)	●(10)	◇	3A	Indoor unit communication circuit (wired remote controller) error
●(4)	●(1)	◇	41	Room temp. sensor error
●(4)	●(2)	◇	42	Indoor unit Heat Ex. Middle temp. sensor error
●(4)	●(4)	◇	44	Human sensor error
●(5)	●(1)	◇	51	Indoor unit fan motor error
●(5)	●(3)	◇	53	Drain pump error
●(5)	●(7)	◇	57	Damper error
●(5)	●(15)	◇	5U	Indoor unit error
●(6)	●(1)	◇	61	Outdoor unit reverse/missing phase and wiring error
●(6)	●(2)	◇	62	Outdoor unit main PCB model information error or communication error

Display mode ● : 0.5s ON / 0.5s OFF
◇ : 0.1s ON / 0.1s OFF
() : Number of flashing

Error display			Wired remote control Error code	Description
OPERATION lamp (green)	TIMER lamp (orange)	ECONOMY lamp (green)		
●(6)	●(3)	◇	63	Inverter error
●(6)	●(4)	◇	64	Active filter error, PFC circuit error
●(6)	●(5)	◇	65	Trip terminal L error
●(6)	●(8)	◇	68	Outdoor unit rush current limiting resistor temp. rise error
●(6)	●(10)	◇	6A	Display PCB microcomputers communication error
●(7)	●(1)	◇	71	Discharge temp. sensor error
●(7)	●(2)	◇	72	Compressor temp. sensor error
●(7)	●(3)	◇	73	Outdoor unit Heat Ex. liquid temp. sensor error
●(7)	●(4)	◇	74	Outdoor temp. sensor error
●(7)	●(5)	◇	75	Suction Gas temp. sensor error
●(7)	●(6)	◇	76	• 2-way valve temp. sensor error • 3-way valve temp. sensor error
●(7)	●(7)	◇	77	Heat sink temp. sensor error
●(8)	●(2)	◇	82	• Sub-cool Heat Ex. gas inlet temp. sensor error • Sub-cool Heat Ex. gas outlet temp. sensor error
●(8)	●(3)	◇	83	Liquid pipe temp. sensor error
●(8)	●(4)	◇	84	Current sensor error
●(8)	●(6)	◇	86	• Discharge pressure sensor error • Suction pressure sensor error • High pressure switch error
●(9)	●(4)	◇	94	Trip detection
●(9)	●(5)	◇	95	Compressor rotor position detection error (permanent stop)
●(9)	●(7)	◇	97	Outdoor unit fan motor 1 error
●(9)	●(8)	◇	98	Outdoor unit fan motor 2 error
●(9)	●(9)	◇	99	4-way valve error
●(9)	●(10)	◇	9A	Coil (expansion valve) error
●(10)	●(1)	◇	A1	Discharge temp. error
●(10)	●(3)	◇	A3	Compressor temp. error
●(10)	●(4)	◇	A4	High pressure error
●(10)	●(5)	◇	A5	Low pressure error
●(13)	●(2)	◇	J2	Branch boxes error [Flexible Multi]