



## Part number UK.KRCS01/Button

A low profile, flush fitting, wall mounted sensor designed as an alternative to the KRCS01-x range of remote return air sensors.

### Features

The UK.KRCS01/Button adds a series of benefits over the traditional box mounted KRCS01-x remote sensors:

- › Discreet, low profile
- › Only requires ½" mounting hole
- › Integrated, secure mounting
- › Flush 7/8" dot only visible indication
- › Can be over painted to match decor
- › Supplied with 8m cable – can be extended using supplied cable connectors
- › Sensor isolated from wall mass to ensure accurate air temperature measurement

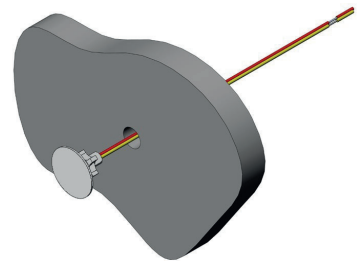

### Kit components

The UK.KRCS01/Button is supplied as a kit of parts, comprising:

- 1 off Low profile button sensor c/w 8m of 2 core cable attached
- 4 off Sealant filled UY2 snap type cable connectors
- 3 off Alternative fan coil unit PCB connectors c/w 0.2m of 2 core cable attached
- 1 off Installation instruction sheet

Discreet room temperature sensing for use where control via the return air temperature is not a viable solution - and where there is a requirement to match the existing room decor.

# Low profile wall sensor

## Installation

The installation of the UK.KRCS01/Button follows four simple steps:

1. Drill a 1/2" hole in the required mounting surface, partially insert the sensor and feed the cable to the fan coil unit.
2. Unplug the existing R1T (return air) sensor from the fan coil unit, select the appropriate PCB connector from the kit and connect to PCB.
3. Employing the UY2 cable connectors, join the cable from the sensor to that of the PCB connector.
4. Clean around previously drilled hole, remove backing tape & fully insert sensor.

If the supplied cable length of 8m is insufficient, then the cable can be extended with the two extra supplied UY2 connectors, and field supplied 22 AWG wire.

## Compatibility

The UK.KRCS01/Button is compatible with any fan coil unit where the KRCS01-1, the KRCS01-4 or the KRCS01-7B are offered as standard remote return air sensor accessories.

## Dimensions

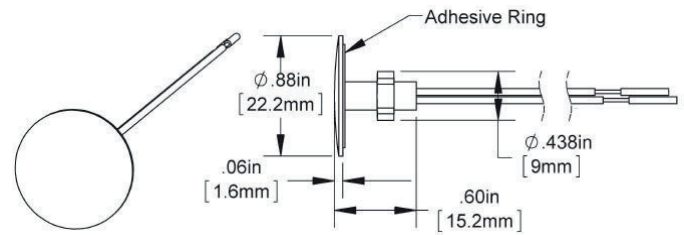

## Availability

The UK.KRCS01/Button is available from w/c 10th February 2020.

The present leaflet is drawn up by way of information only and does not constitute an offer binding upon Daikin UK. Daikin UK has compiled the content of this leaflet to the best of its knowledge. No express or implied warranty is given for the completeness, accuracy, reliability or fitness for particular purpose of its content and the products and services presented therein. Specifications are subject to change without prior notice. Daikin UK explicitly rejects any liability for any direct or indirect damage, in the broadest sense, arising from or related to the use and/or interpretation of this leaflet. All content is copyrighted by Daikin UK.

