

Receiver Unit

INSTALLATION INSTRUCTION SHEET

(PART NO. 9378626027-02)

For authorized service personnel only.

DANGER

This mark indicates procedures which, If improperly performed, are most likely to result in the death of or serious injury to the user or service personnel.

Never touch electrical components immediately after the power supply has been turned off. Electrical shock may occur. After turning off the power, always wait 5 minutes or more before touching electrical components.

WARNING

This mark indicates procedures which, if improperly performed, might lead to the death or serious injury of the user.

① For the air conditioner to operate satisfactorily, install it as outlined in this installation instruction sheet.

② Installation work must be performed in accordance with national wiring standards by authorized personnel only.

③ Do not cut, shorten, or extend the wire in the standard parts.

④ Do not turn on the power until all installation work is complete.

Let the customer keep this installation instruction sheet because it is needed when the air conditioner or receiver unit is serviced or moved.

CAUTION

This mark indicates procedures which, if improperly performed, might possibly result in personal harm to the user, or damage to property.

① Do not wire the receiver unit wire together with or parallel to the connection cables, transmission cords, remote control cords, bus wire and power supply cords of the indoor and outdoor units. It may cause erroneous operation.

② Do not install the receiver unit wire near a source of electromagnetic waves.

③ Do not install where there is the danger of combustible gas leakage.

④ Do not install near heat sources, steam.

1 STANDARD PARTS		
The following installation parts are supplied. Use them as required.		
Name and Shape	Q'ty	Application
Receiver unit	1	For receiving the signal from the remote control unit
Cover	1	For covering receiver unit
Insulation	1	For protecting PCB from dust
Receiver unit wire A (5 m)	1	For connecting receiver unit wire B to receiver unit
Receiver unit wire B (0.2 m)	1	For connecting receiver unit wire A to PCB of indoor unit
Hook metal	1	For installing receiver unit to indoor unit
Bracket (cover)	1	For fixing receiver unit to the wall or ceiling
Screw (M3 × 12)	2	For installing remote control unit holder to the wall
Name and Shape	Q'ty	Application
Screw (M4 × 20)	2	For installing receiver unit to the wall or ceiling
Screw (M4 × 12)	4	For installing hook metal and fixing cord clamp
Cord clamp	1	For fixing receiver unit wire A
Remote control unit	1	Use for air conditioner operation
Battery (R03/LR03)	2	For remote control unit
Remote control unit holder	1	Use as remote control unit holder

2

OPTIONAL PARTS

Name and Shape	Q'ty	Application	Part No.	Corresponding Receiver Unit
Receiver unit wire C (10 m)	1	For extending the receiver unit wire	9707598025	UTY-LRJY1 UTY-LRJG1 UTY-LRJX1
			9707600025	UTY-LRJT1

3

SELECTING THE INSTALLATION LOCATION

Consult the customer and determine the installation location according to the following:

① The receiver unit wiring can be extended up to 10 m. (To extend the wiring, purchase the optional receiver unit wire C.)

② The signal reception angle of the receiver unit is shown in the figures to the right.

③ Do not install the receiver unit near a fluorescent light. (The unit must be at least 1 m away from a light source.)

④ Do not install the receiver unit where it will be exposed to direct sunlight.

⑤ Do not install the receiver unit where it will be exposed directly to the airflow from the indoor unit.

4

FUNCTIONS AND DIMENSION

Unit: mm

5

INSTALLING THE RECEIVER UNIT

CAUTION

① Do not touch the PCB or PCB parts of receiver unit directly with your hands.

② Fixing of the holder cover with the screws in the standard parts may be unsuitable if the wall or ceiling material is weak. If so, prepare screws suitable for the wall or ceiling material, and fix it.

(1) Select the wiring pattern.
[Pattern A] From the top of the receiver unit: No additional work is necessary.
[Pattern B] From behind the receiver unit: Perform the following procedure to route the wiring behind the receiver unit.① Remove the screw.
② Remove the holder (PCB) from the holder cover.

Route the wiring as shown in the figure.

① Reattach holder cover. (Make sure that the hook on the holder cover is caught on the holder [PCB].)
② Fix holder (PCB) by the screw.(2) Select the installation method.
[Method 1] Receiver unit embedded in the wall or ceiling: Refer to "I. Embedding the receiver unit."
[Method 2] Receiver unit attached to the wall or ceiling: Refer to "II. Attaching the receiver unit."
[Method 3] Receiver unit cannot be embedded in or attached to the wall or ceiling: Refer to "III. Attaching the receiver unit to the indoor unit."
I. Embedding the receiver unit (Wiring pattern A or B)

Unit: mm

60-64

120-140

Screws (M4 × 20)

Cover

Bracket (cover)

Cover

① Install the cover. Hook the two projections on the top of the cover onto the bracket (cover), and then hook the projection on the bottom of the cover onto the bracket (cover).
② Make sure that there is no gap between the cover and the wall or ceiling.

II. Attaching the receiver unit (Wiring pattern B)

① Remove the screw.
② Remove the holder (PCB) from the holder cover.

Cut the projections in the areas indicated with a circle and remove them. (Be careful not to injure yourself on the cut edges of the holder cover.)

① Affix the insulation to the holder cover.
② Attach the holder cover to the wall or ceiling with the screws (included with the standard parts).① Reattach holder cover. (Make sure that the hook on the holder cover is caught on the holder [PCB].)
② Fix the holder (PCB) by the screw.① Affix the insulation to the holder cover.
② Attach the hook metal to the holder cover with the screw (included with the standard parts).

Attach the hook metal to the indoor unit with the screw(s).

III. Attaching the receiver unit to the indoor unit (Wiring pattern A or B)

① Remove the screw.
② Remove the holder (PCB) from the holder cover.

Cut the projections in the areas indicated with a circle and remove them. (Be careful not to injure yourself on the cut edges of the holder cover.)

① Reattach holder cover. (Make sure that the hook on the holder cover is caught on the holder [PCB].)
② Fix the holder (PCB) by the screw.① Affix the insulation to the holder cover.
② Attach the hook metal to the holder cover with the screw (included with the standard parts).

Attach the hook metal to the indoor unit with the screw(s).

6

WIRING

WARNING

① Before starting work, make sure that power is not being supplied to the indoor unit.

② Always fasten the outside covering of the connection cord with the cord clamp. (If the insulator is chafed, electric leakage may occur.)

CAUTION

① Do not touch the PCB or PCB parts of indoor unit directly with your hands.

② When fixing the wiring, be careful to avoid touching the edge of the indoor unit or the control box.

③ Install the remote controller wires so as not to be direct touched with your hand.

④ Make sure to use and roll an insulation tube of more than 1 mm thick at the connection point of the receiver unit wire A and the receiver unit wire B.

PROCEDURE

(1) To remove the control box cover, referring to the installation instruction sheet of indoor unit.

(2) Connect receiver unit wire B to CN13 on the PCB.

(3) Switch DIP SW. (Referring to 7 of this installation instruction sheet)

(4) Wire as per below diagram.

(5) Fix the receiver unit wire A with CORD CLAMP and SCREW.

(6) Reattach the control box cover.

NOTE

Use the cord clamp and the screw (M4 × 12) in the standard parts.

If the wiring length is 10 m, replace with receiver unit wire C (optional parts).
Receiver unit wire A (5 m)

Connect the wires, and then use heat shrink tubing to protect the connection from dust and water droplets.

EXAMPLE

After shrinking both ends of the heat shrink tubing, seal the ends with electrical tape.

Receiver unit

Provide a trap in the receiver unit wiring. (To prevent water droplets from entering the receiver unit)

(Continued to the next page)

CAUTION

- ① When setting DIP switches, do not touch any other parts on the circuit board directly with your bare hands.
- ② Be sure to turn off the main power.
- ③ Without setting remote controller (DIP SW4-1) as shown on below table, cannot operate with wireless remote controller.

Setting of wireless remote controller and wired remote controller can be switched by DIP SW4-1.
Switch as per below diagram.

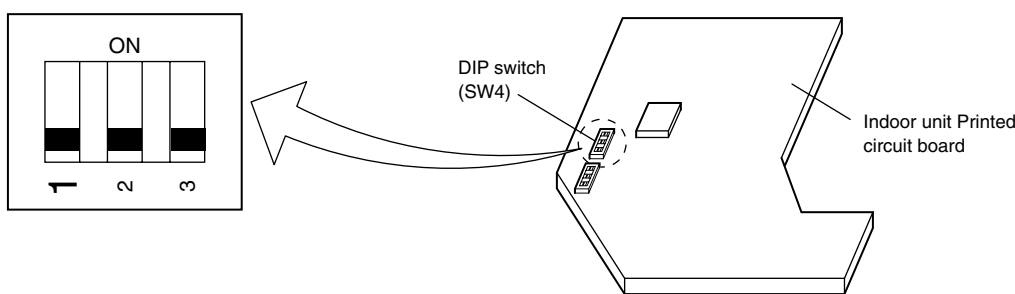

INDOOR UNIT TYPE	REMOTE CONTROLLER SETTING	DIP SW4		
		1	2	3
INVERTER MODELS	WIRED REMOTE CONTROLLER (Factory-set)	OFF	—	—
	WIRELESS REMOTE CONTROLLER	ON	—	—
NON-INVERTER MODELS	WIRED REMOTE CONTROLLER (Factory-set)	ON	—	—
	WIRELESS REMOTE CONTROLLER	OFF	—	—

- ① Turn on the breaker.
- ② Make sure that the operation indicator lamp and timer indicator lamp are slowly flashing alternately.
 - If the auto restart function has been set, the air conditioner will operate with the settings immediately before the power supply was turned off.
 - If an error has occurred, the lamps on the receiver unit will flash quickly to indicate the error code. (Referring to 11 of this installation instruction sheet)

1. LOAD BATTERIES (R03/LR03 × 2)

- ① Press and slide the battery compartment lid on the reverse side to open it. Slide in the direction of the arrow while pressing the mark.
- ② Insert batteries.
Be sure to align the battery polarities (\oplus/\ominus) correctly.
- ③ Close the battery compartment lid.

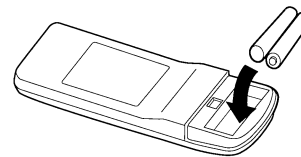
**CAUTION**

- ① Take care to prevent infants from accidentally swallowing batteries.
- ② When not using the Remote Control Unit for an extended period, remove the batteries to avoid possible leakage and damage to the unit.
- ③ If leaking battery fluid comes in contact with your skin, eyes, or mouth, immediately wash with copious amounts of water, and consult your physician.
- ④ Dead batteries should be removed immediately and disposed of properly, either in a battery collection receptacle or to the appropriate authority.
- ⑤ Do not attempt to recharge dry batteries.

NOTE

- Never mix new and used batteries, or batteries of different types.

2. INSTALLING THE REMOTE CONTROL UNIT HOLDER**CAUTION**

- ① Check that the indoor unit correctly receives the signal from the remote control unit, then install the remote control unit holder.
- ② Select the remote control unit holder selection site by paying careful attention to the following:
Avoid places in direct sunlight.
Select a place that will not be affected by the heat from a stove, etc.

- Install the remote control unit with a distance of 5 m between the remote control unit and the signal receiver of the receiver unit as the criteria. However, when installing the remote control unit, check that it operates positively.
- Install the remote control unit holder to a wall, pillar, etc. with the screw.

- ① Mount the Holder.
- ② Set the Remote Control Unit.
- ③ To remove the Remote Control Unit (when use at hand).

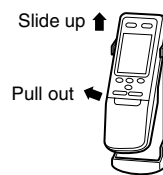
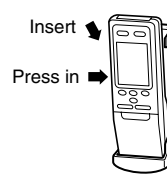
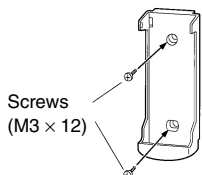

When two or more air conditioners are installed in a room and the remote control unit is operating an air conditioner other than the one you wish to set, change the signal code of the remote control unit to operate only the air conditioner you wish to set (four selections possible).

When two or more air conditioners are installed in a room, please contact your retailer to set the individual air conditioner signal codes.

- Confirm the setting of the remote control unit signal code and the printed circuit board setting.
If these are not confirmed, the remote control unit cannot be used to operate for the air conditioner.

Remote Control Unit Settings

Use the following steps to select the signal code of the remote control unit. (Note that the air conditioner cannot receive a signal code if the air conditioner has not been set for the signal code.)

- ① Press the START/STOP button and display only the clock.

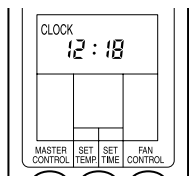

- ② Press the MASTER CONTROL button continuously for more than five seconds to display the current signal code.

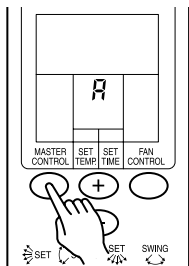

- ③ Change the signal code with the \oplus/\ominus button ($A \rightarrow b \rightarrow c \rightarrow d$).

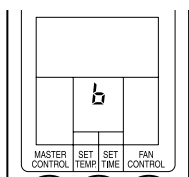

- ④ Press the MASTER CONTROL button again to return to the clock display and change the signal code.

If no buttons are pressed within 30 seconds after the signal code is displayed, the system returns to the original clock display. In this case, start again from step 1.

The air conditioner signal code is set to A prior to shipment. Contact your retailer to change the signal code.

The remote control unit resets to signal code A when the batteries in the remote control unit are replaced. If you use a signal code other than signal code A, reset the signal code after replacing the batteries.
If you do not know the air conditioner signal code setting, try each of the signal codes ($A \rightarrow b \rightarrow c \rightarrow d$) until you find the code which operates the air conditioner.

Indoor Unit Setting

Jumper wire		Remote control unit signal code
JM2	JM3	
Connect	Connect	A (Factory-set)
Connect	Disconnect	B
Disconnect	Connect	C
Disconnect	Disconnect	D

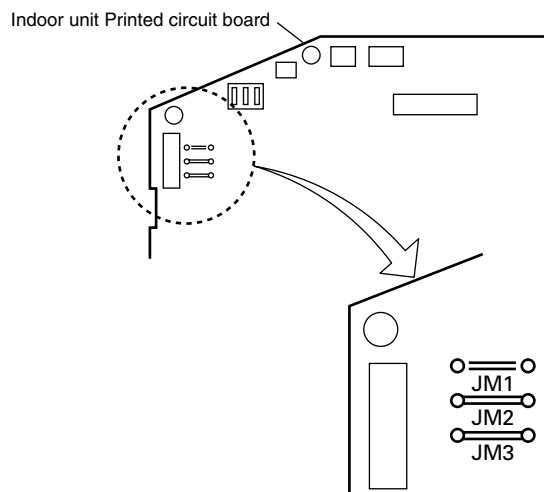
**CAUTION**

When cutting the jumper wire, be careful to avoid damaging other parts of the printed circuit board.

CHECK ITEMS

- (1) Is operation of each button on the remote control unit normal?
 - (2) Does each lamp light normally?
 - (3) Is the drain normal?
 - (4) Is there any abnormal noise and vibration during operation?
- Do not operate the air conditioner in the running state for a long time.
 - Test running

When the air conditioner is run by pressing the remote control unit test run button, the OPERATION and TIMER indicator lamps flash slowly at the same time.

[OPERATION METHOD]

- For the operation method, refer to the operating manual.
 - The outdoor unit may not run, depending on the room temperature.
- In this case, the 'TEST RUN' signal is received during air conditioner operation (use a metallic object to short the two metal contacts under the battery compartment lid and send the 'TEST RUN' signal from the remote control unit).

[ERROR CONTENTS]

OPERATION indicator lamp (GREEN)	TIMER indicator lamp (ORANGE)	3rd lamp (RED)	Error contents
○	○	×	Indoor EEPROM abnormal
(2 times) ●	○	×	Indoor room temperature sensor open
(2 times) ●	○	○	Indoor room temperature sensor shortcircuited
(3 times) ●	○	×	Indoor heat exchanger temperature sensor open
(3 times) ●	○	○	Indoor heat exchanger temperature sensor shortcircuited
(4 times) ●	○	×	Float switch operated
(5 times) ●	○	×	Indoor signal abnormal
(5 times) ●	○	○	Outdoor signal abnormal
(6 times) ●	○	×	Indoor fan abnormal
** ○	(2 times) ●	×	Outdoor power source connection abnormal
○	(3 times) ●	×	Outdoor heat exchanger temperature sensor open
** ○	(3 times) ●	○	Outdoor heat exchanger temperature sensor shortcircuited
○	(4 times) ●	×	Outdoor temperature sensor open
○	(4 times) ●	○	Outdoor temperature sensor shortcircuited
○	(5 times) ●	×	Outdoor discharge pipe temperature sensor open
○	(5 times) ●	○	Outdoor discharge pipe temperature sensor shortcircuited
○	(6 times) ●	×	Outdoor high pressure abnormal
** ○	(7 times) ●	×	Outdoor discharge pipe temperature abnormal
* ○	(8 times) ●	×	Compressor thermistor abnormal
* ○	(9 times) ●	×	Pressure switch abnormal
* ○	(10 times) ●	×	Current trip abnormal
* ○	(11 times) ●	×	CT abnormal
* ○	(12 times) ●	×	Active filter abnormal
* ○	(13 times) ●	×	Compressor position detection abnormal
* ○	(14 times) ●	×	Outdoor fan abnormal
* ○	×	(5 times) ●	Serial abnormal (Inverter → Multi controller)
* ○	×	(2 times) ●	2-way valve thermistor abnormal
* ○	×	(3 times) ●	3-way valve thermistor abnormal
* ○	×	(4 times) ●	Connected indoor unit distinguishing abnormal

○ : 0.1s ON/0.1s OFF (flash) ● : 0.5s ON/0.5s OFF (flash) × : OFF
* : INVERTER MODEL ONLY ** : NON-INVERTER MODEL ONLY

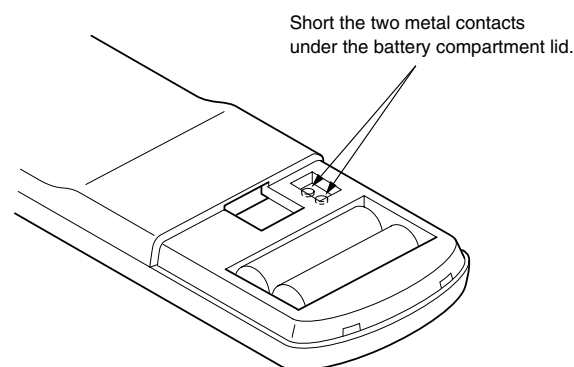

- To end test operation, press the remote control unit START/STOP button.
(When the air conditioner is run by pressing the remote control unit TEST RUN button, the OPERATION and TIMER indicator lamps will simultaneously flash slowly.)